

ELO40



SMHC1



ELO40

## SELF-CHECKING HIGH WATER LEVEL CONTROLLER

### GENERAL FEATURES

Regarding the operation and the controlling of the boilers, rules and regulations are subject to change due to country's applications. Nevertheless, it is clearly shown in the regulations that boilers should be operated safely without the assistance of a person when there is high-safety concern. To set high or low water level of a boiler, the design condition should be carefully inspected. Any amount above or below design limit of boiler may lead to dangerous events or inefficient working operations. These are the possible deficiencies of uncontrolled high water level:

- The transfer of water to steam may cause in malfunctioning due to dirt and / or failure of the steam system components (valve, pipe, system, process, etc.).
- Wet and dirty steam may contaminate or disrupt the produced steam. Wet steam may increase the water film thickness which may reduce the heat transfer, eventually may result in lower processing temperatures. This will cause low efficiency, increase in process duration and unit cost.

- Overfilled boiler may cause splash, damage in process and injuries of people.

With all above deficiencies, below results may occur.

Poor quality steam production, lower production rates, poor product quality. Increased maintenance cost of plant and components, damage to steam systems, possible personnel injuries

To prevent all these possible deficiencies, high level water controller should be used to control the water pump, shutting-off burner, switching off supply water valve and giving alarm to warn personnels.

Taken precautions can vary by the requirements of facilities.

### ELO40 LEVEL PROBE

**Protective Tube:** Stainless Steel

**Probe:** Stainless Steel

**Insulator:** PTFE

**Socket:** Polyamide

**Sealing Ring:** Metal Gasket

**Connection:** 1/2" Threaded

**Max. Working Pressure:** 32 bar

**Max. Working Temperature:** 239 °C

### SMHC1 CONTROL UNIT

**Power Supply:** 230 V / 50-60 Hz

**Input:** 4,5 VA

**Fuse:** 80 mA / T

**Protection Class:** IP40

# ELO40 SELF-CHECKING HIGH WATER LEVEL CONTROLLER

## TECHNICAL SPECIFICATIONS

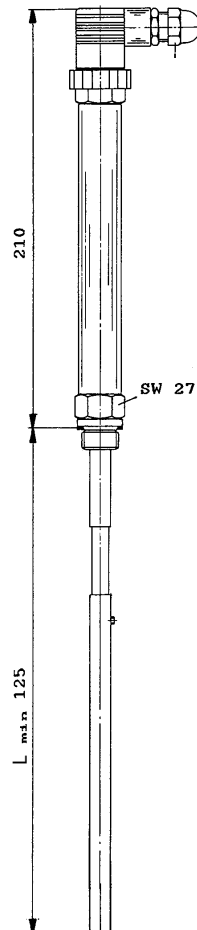
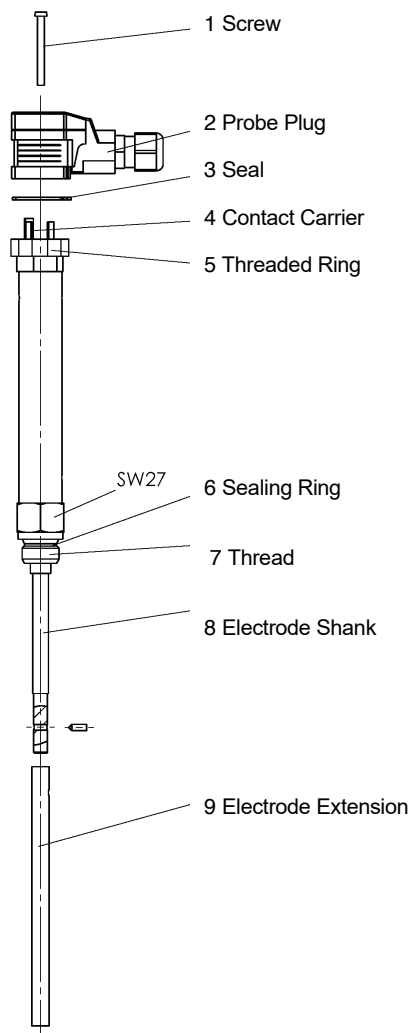
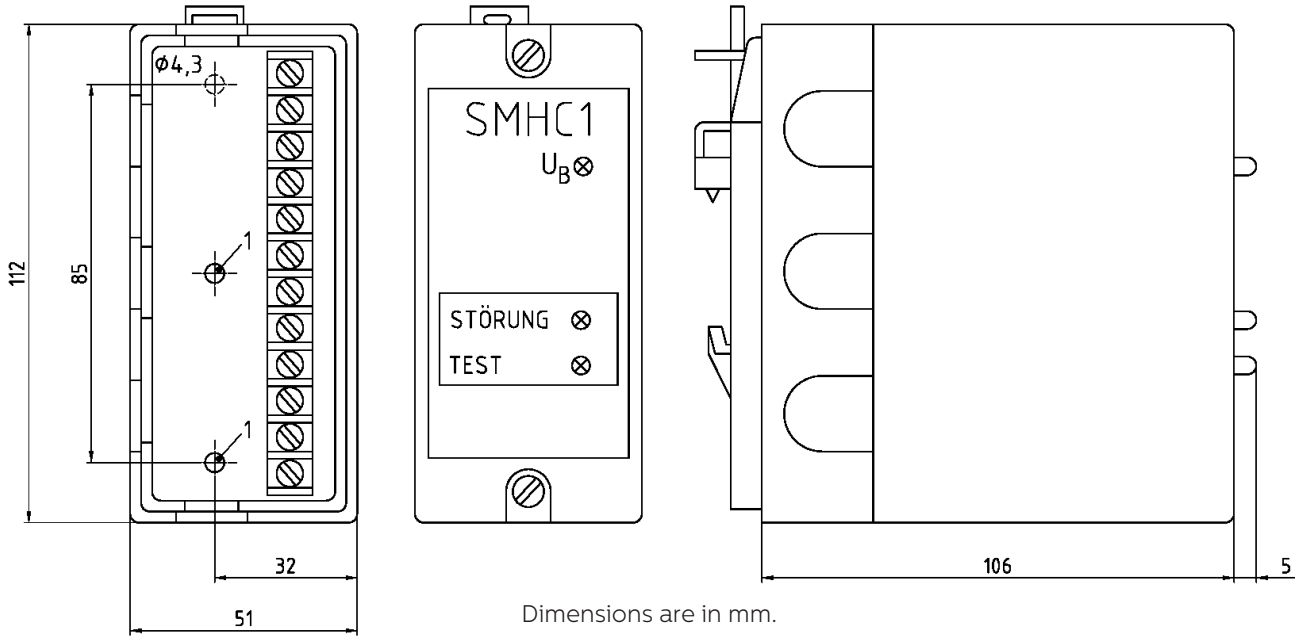

ELO30
L= 500 mm
L= 1000 mm
L= 1500 mm
L= 2000 mm

L electrode length can be produced to the desired size.

# ELO40 SELF-CHECKING HIGH WATER LEVEL CONTROLLER

## ELECTRICAL CONNECTION SCHEME

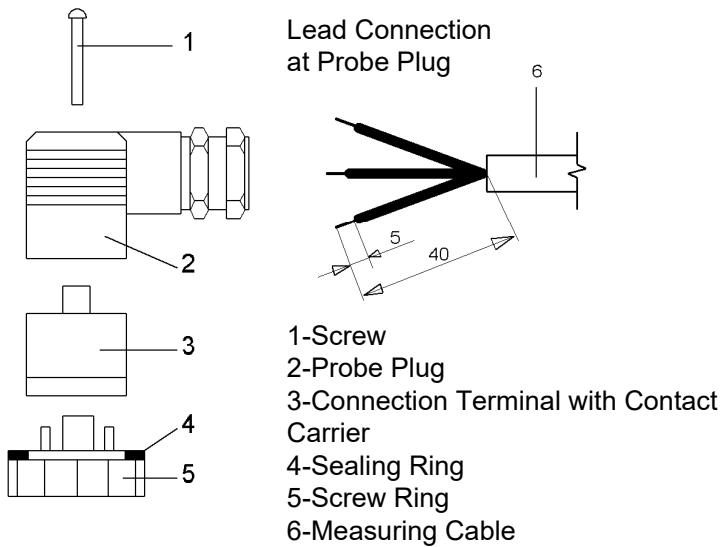
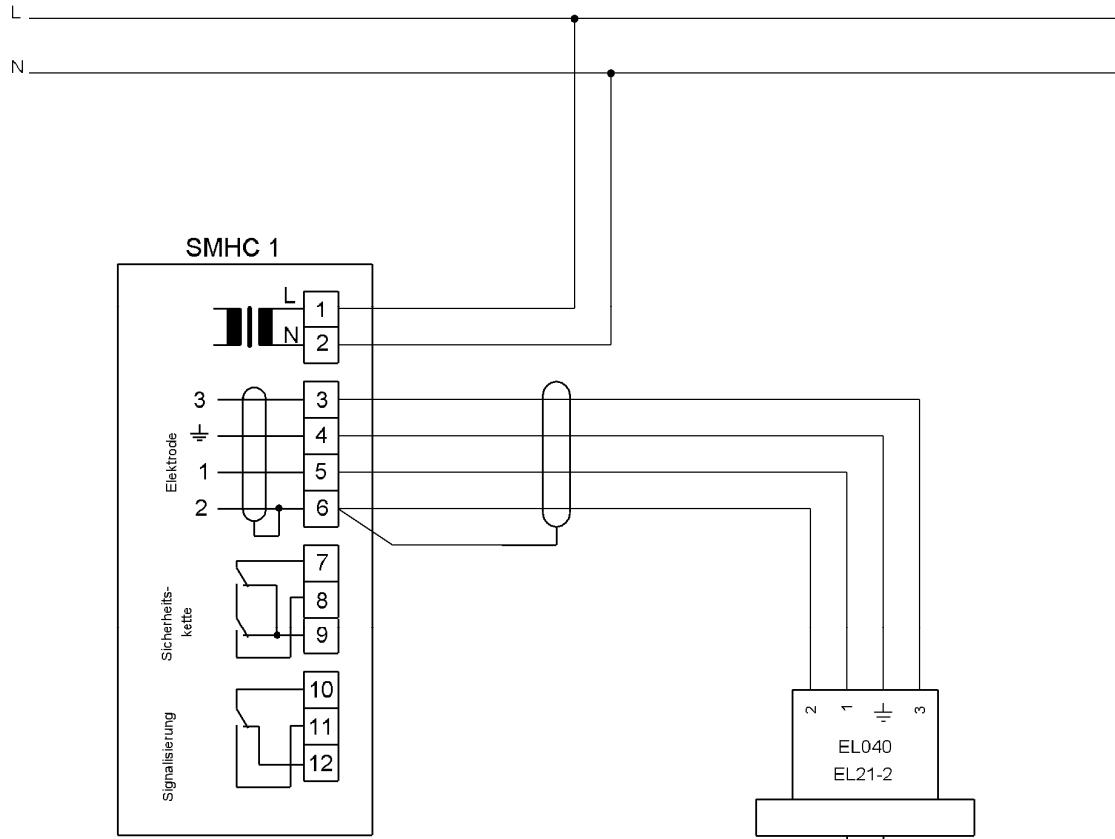

# ELO40 SELF-CHECKING HIGH WATER LEVEL CONTROLLER

## SELF-CHECKING HIGH WATER LEVEL CONTROLLER



### HEAD OFFICE - FACTORY

Atatürk Sanayi Bölgesi Hadımköy Mahallesi Mustafa İnan Caddesi No: 44 Arnavutköy - İSTANBUL  
Tel: +90 212 771 01 45 (pbx) | Fax: +90 212 771 47 27  
info@ayvaz.com | www.ayvaz.com

#### **Cona Caserta/Italy**

Tel: +39 0823 187 3988  
rmolaro@ayvaz.com

#### **Ayvaz Germany Viernheim/Germany**

Tel: +49 62046014399  
germany@ayvaz.com

#### **Ayvaz Ukraine Kiev/Ukraine**

Tel: +380 44 390 57 57  
info@ayvaz.com.ua

#### **Tricorr Warsaw/Poland**

Tel: +48 530 030 810  
+48 533 603 335  
tricorr@tricorr.eu

#### **Ayvaz Azerbaijan Baku/Azerbaijan**

Tel: +99 (455) 579-84-32  
ahayatov@ayvaz.com

#### **Ayvaz Egypt Cairo/Egypt**

Tel: +20 122 819 78 29  
andrew.eid@ayvaz.com

#### **Ayvaz Gulf Dubai/U.A.E**

Tel: +971 563550822  
+971 501306871  
mideast@ayvaz.com

#### **Ayvaz China Ningbo/China**

Tel: +86 152 5830 7361  
msahin@ayvaz.com

#### **Ayvaz Kazakhstan LLP Almaty/Kazakhstan**

Tel: +7 (727) 327 97 57  
info\_kz@ayvaz.com

#### **Ayvaz N Ispirih/Bulgaria**

Tel: +359 8431 27 32  
office@ayvaz-n.eu

#### **Ayvaz Serbia Belgrade/Serbia**

Tel: +381 61 658 70 52  
yakbiyik@ayvaz.com

#### **Ayvaz Vietnam HCMC/Vietnam**

Tel: +84 89 8508345

#### **Ayvaz Americas Rhode Island/USA**

Tel: +1 401 737 8380  
americas@ayvaz.com